

77°
TOWN
CENTRE

77° LIFE

DivyaSree

LIFE'S COMING TOGETHER.

CONSTRUCTION UPDATE

DECEMBER 2024 ➡

77 Life_FY 24-25_Q3_Report 11



CONSTRUCTION SCHEDULE MACRO SCHEDULE

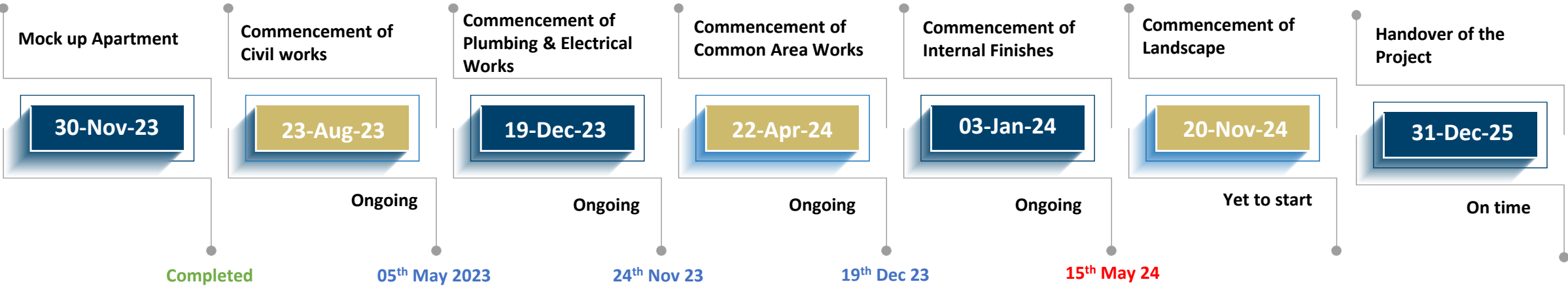

PAYMENT MILESTONES TENTATIVE

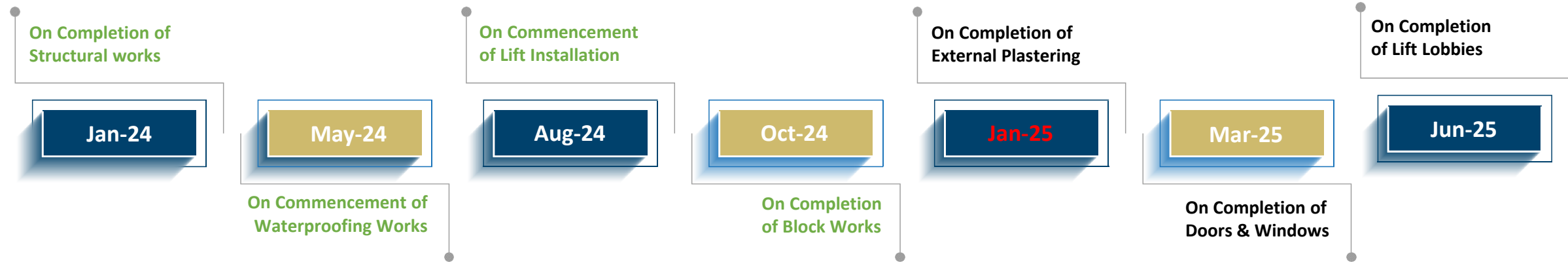

Dates: Color code
Green: Completed Blue: Started Early Red: Delayed

* The construction progress schedule presented in this report is subject to change based on evolving project conditions and unforeseen factors.

SPECIFICATION UPGRADES

77° LIFE

LIFE'S COMING TOGETHER.

Flooring and Dado

All Bedrooms	Engineered Wooden Flooring
All Bathrooms	Flooring in Imported Marble, Dado in Premium Vitrified
Powder Rooms	Flooring in Imported Marble, Dado in Premium Vitrified

Plumbing and Bathroom Fixtures

Bathroom Counter	Imported Marble for the Counters
Kitchen Counter and Sink	Quartz Counter (uninstalled)

False Ceiling

Apartment	Gypsum False ceiling with LED concealed lighting as per default design
Toilet	Modular False Ceiling with Calcium Silicate Board Tiles or Equivalent

Power Supply; Electrical and Communication Systems

Wiring	Concealed FRLS Wiring in PVC conduits
Earthing	Earth Leakage Circuit Breaker (ELCB) and Miniature Circuit Breakers (MCB)

Doors and Windows

Main Door	8' Solid Core Double Leaf Doors with Designer Veneer
Internal Doors	7' Solid Core Veneered Flush Doors
Bathroom Doors	7' Solid Core Flush Doors with Veneer & laminate

Utilities & Services

Solar Water Heater	Provided as per M.O.E.F Norms (for Specific Apartments)
Elevators	Schindler or Equivalent

KEY PLAN 2 DIMENSIONAL

Terrace:
Sky Zone Tennis
Court & Wellness
Deck

Level 11 & 12
Ignis Zone
Social Deck

Level 7 & 8
Oasis Zone -
Kid's
Entertainment &
Swimming Pool

Level 2
Terra Zone
Fitness & Indoor
Games

Level 1
Lobby Zone

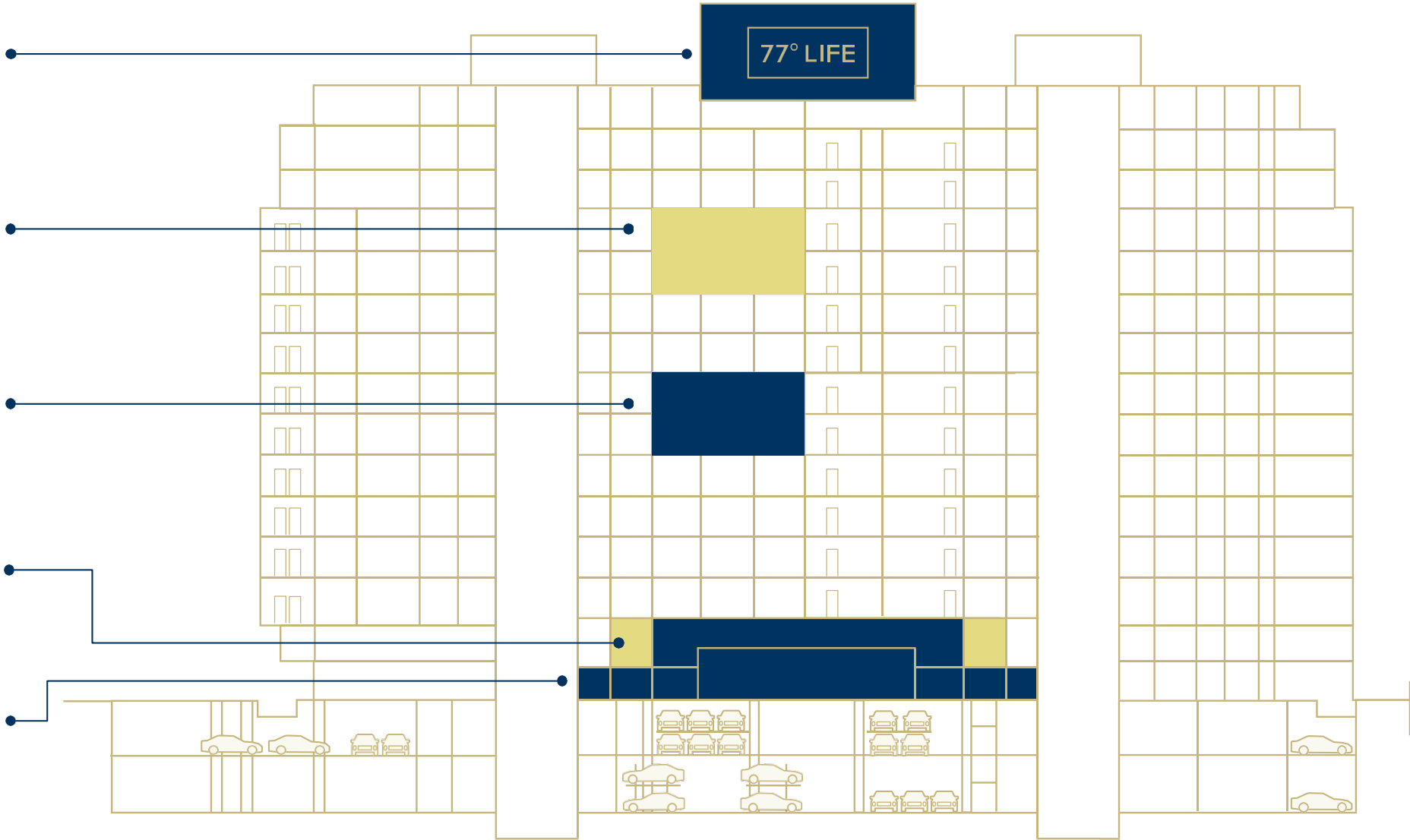

PROJECT PROGRASS STATUS

STRUCTURAL WORKS COMPLETED

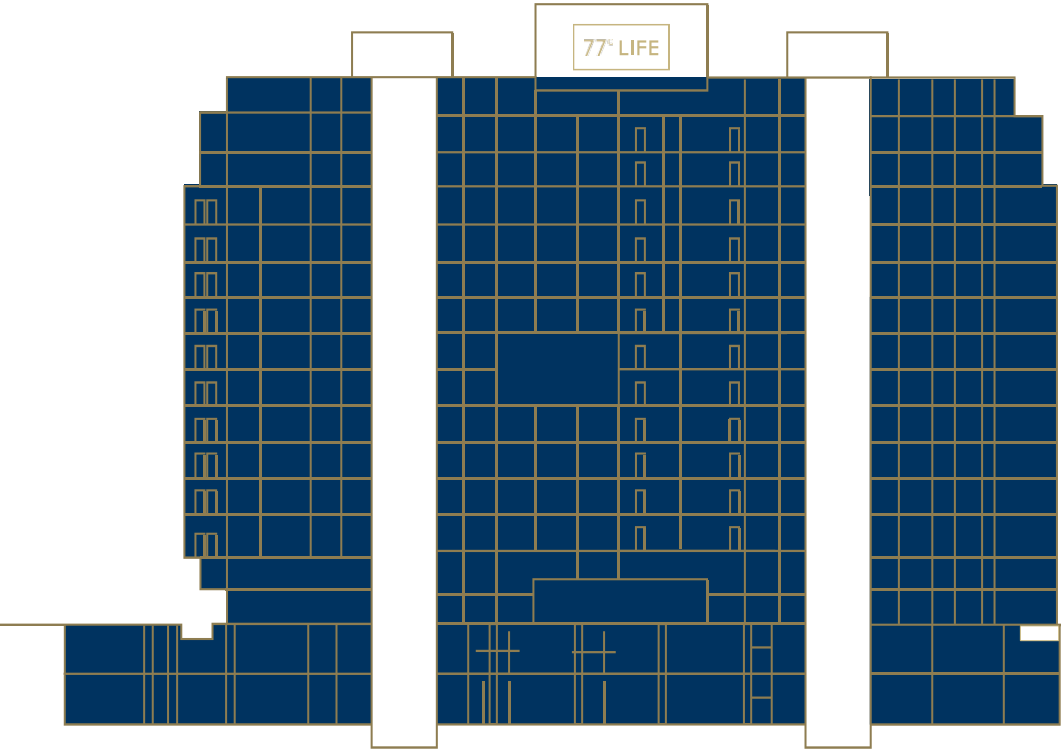

COMPLETED

PROGRESS SINCE LAST REPORT

BLOCK WORK COMPLETED

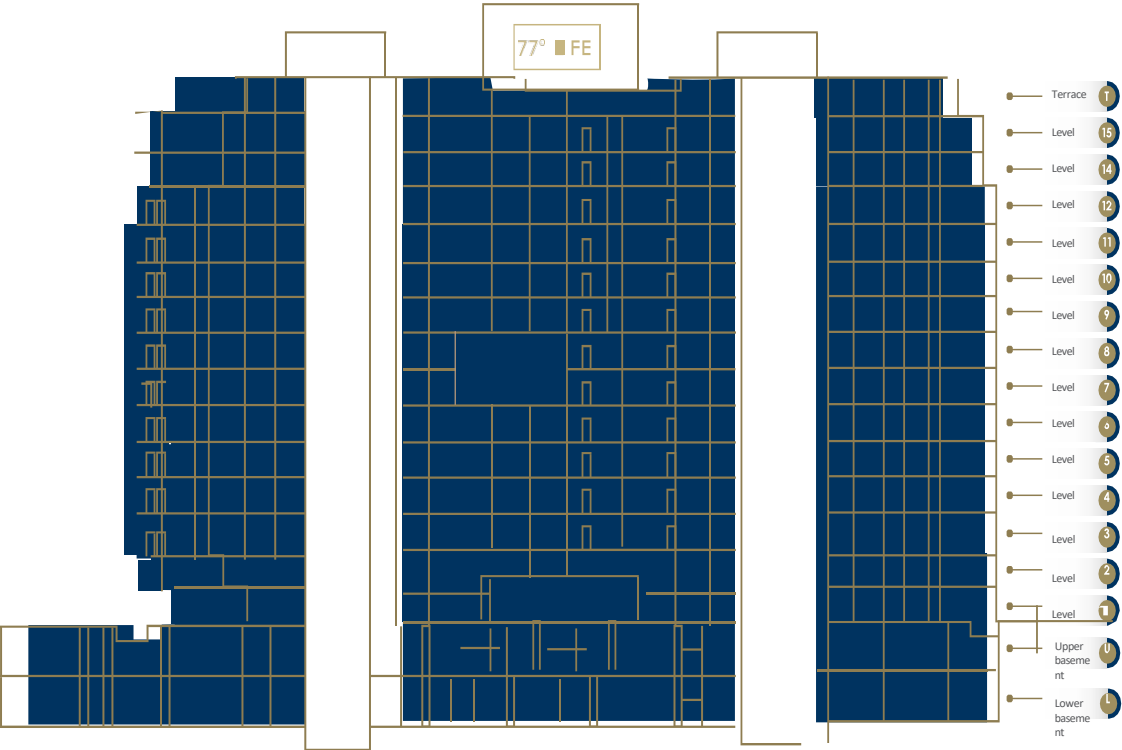

IN PROGRESS

PROJECT PROGRASS STATUS

WATER PROOFING
IN PROGRESS

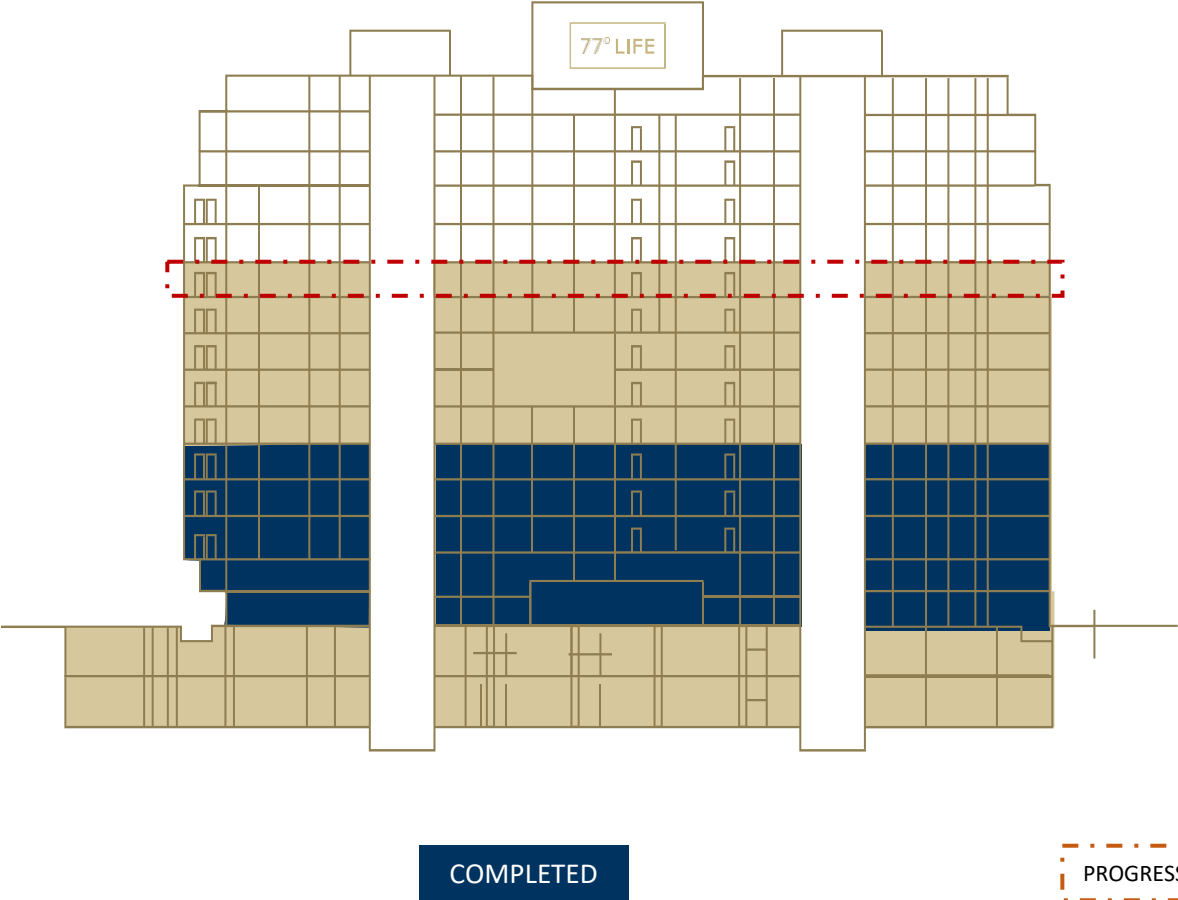

INTERNAL PLASTERING
IN PROGRESS

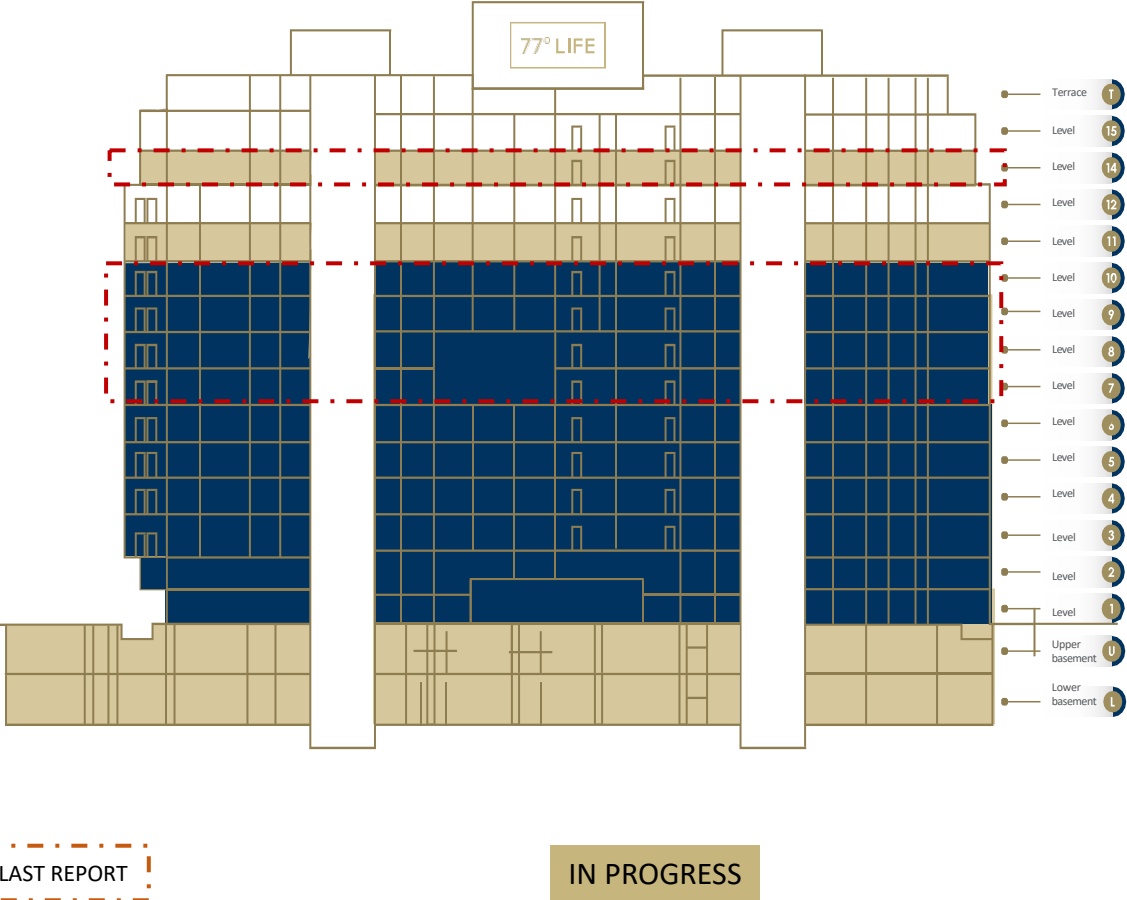

PROJECT PROGRESS STATUS

PLUMBING & ELECTRICAL WORKS IN PROGRESS

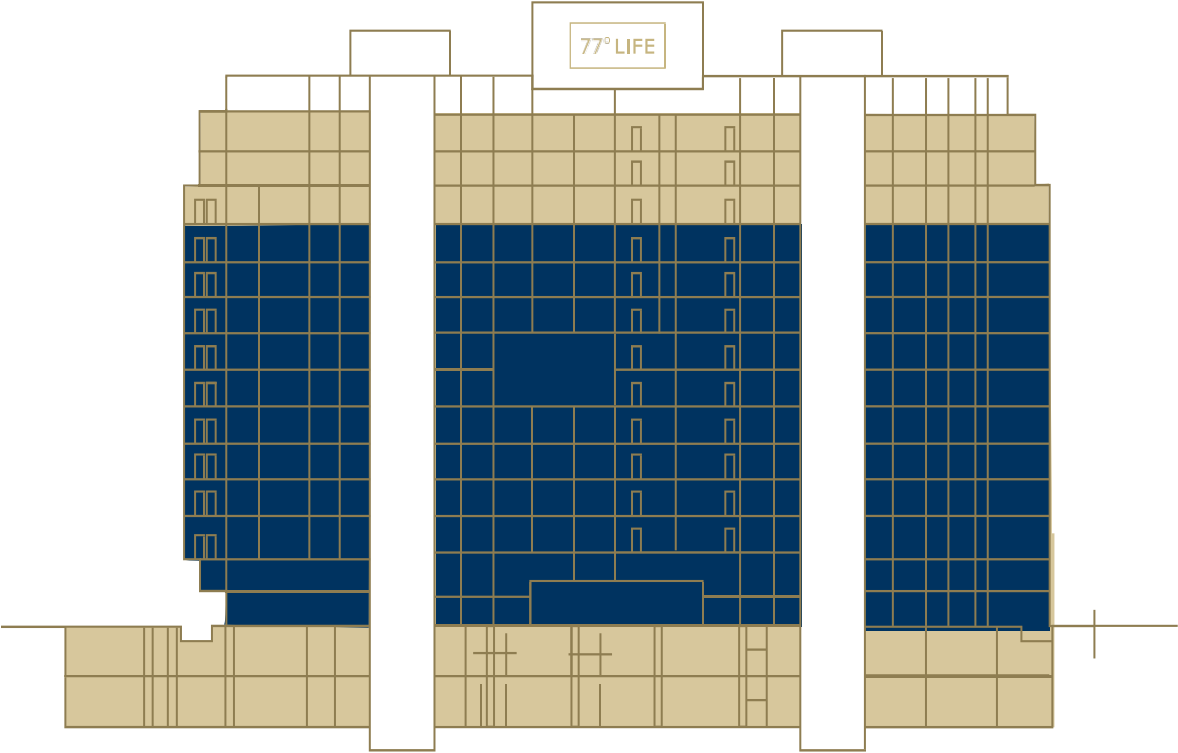

COMPLETED

PROGRESS SINCE LAST REPORT

FLOORING WORKS IN PROGRESS

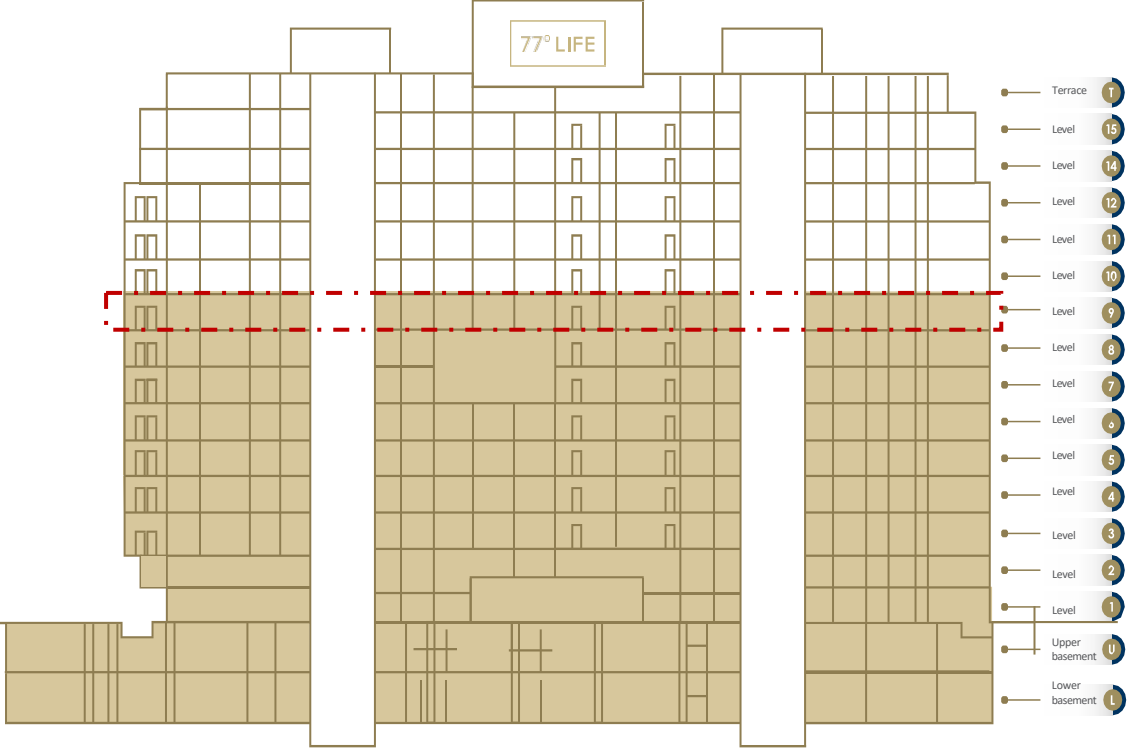

IN PROGRESS

- Terrace 1
- Level 15
- Level 14
- Level 12
- Level 11
- Level 10
- Level 9
- Level 8
- Level 7
- Level 6
- Level 5
- Level 4
- Level 3
- Level 2
- Level 1
- Upper basement
- Lower basement

PROJECT PROGRESS COMMON AREA



77° LIFE

LIFE'S COMING TOGETHER.

Lift Door
Fixing in
Progress



Level 8 & 9
Staircase
works in
Progress



PROJECT PROGRESS COMMON AREA

77° LIFE

LIFE'S COMING TOGETHER.

Basement:
Services works in progress (70% Completed)



Arrival Area:
Flooring works in progress (10% Completed)



PROJECT PROGRESS **UNIT STATUS** —————>

A 0304 – Utility works completed



A 0304 – Toilet works completed



PROJECT PROGRESS UNIT STATUS —→

77° LIFE

LIFE'S COMING TOGETHER.

A 0508 – False Ceiling works in progress



A 0504 – Toilet Dado works in progress

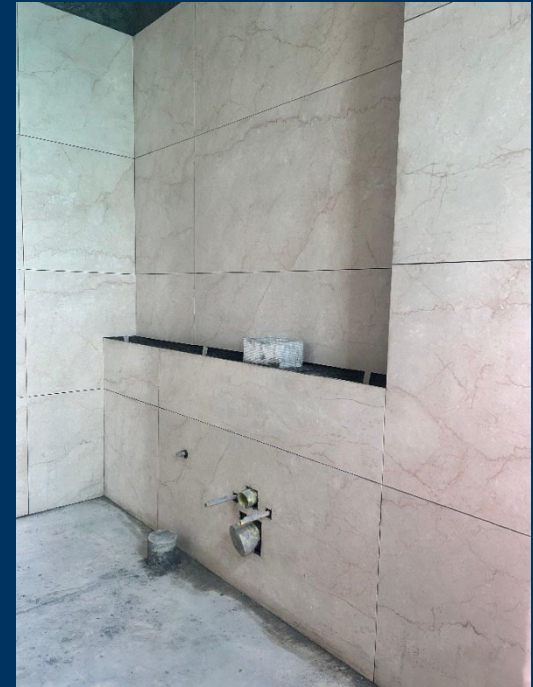

PROJECT PROGRESS **UNIT STATUS** —————>

A 0510 – False Ceiling works in progress



A 0609 – Waterproofing check in progress



PROJECT PROGRESS UNIT STATUS —→

77° LIFE

LIFE'S COMING TOGETHER.

A 0805 – AC
Copper
piping works
in progress



A 1002 –
Waterproof
works in
progress



14th Level External Plastering works in progress



Atrium external plastering works in progress



PROJECT ARTIST IMPRESSION OF AMINITIES

77° LIFE

LIFE'S COMING TOGETHER.

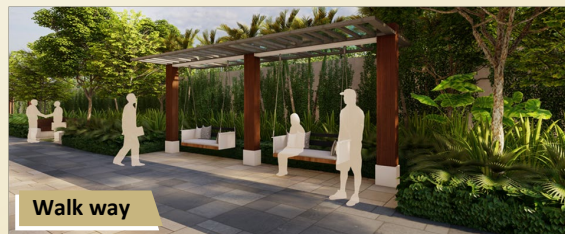

77° LIFE

DivyaSree

New Goals, Learnings, and Beginnings!



Wishing you a
HAPPY NEW YEAR

Thank you

*Do reach out to us in case you need any further
information and / or clarification.
We are happy to be of service!*

 www.77life.co.in

 +91 99002 48401

 crm@77towncentre.co.in

PRM/KA/RERA/1251/446/PR/211222/005551 For more detail visit <https://rera.karnataka.gov.in>.

The developer reserves the absolute right to change, omit, delete, add or revise amenities, specifications or any other details without notice.

Images used for representation purpose only. *T&C Apply